

8 FOOT BENCH
 LENGTH OF AVAILABLE BENCHES: 4', 5', 6', 8'
 BENCHES OF LESS THAN 8' LENGTH
 HAVE 2 LEGS

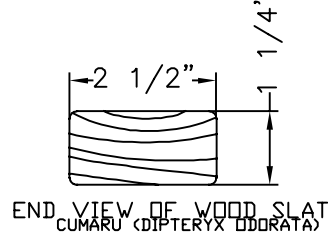
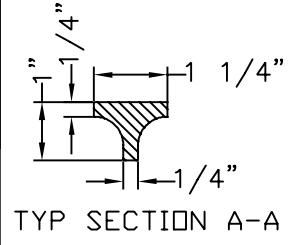
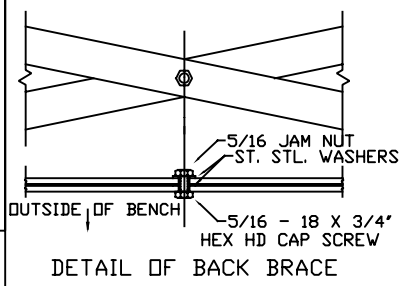

KENNETH LYNCH & SONS
 114 WILLENBROCK ROAD OXFORD, CT 06478
 PHONE 203-264-2831 INFO@KLYNCHANDSONS.COM

6737G-8' WORLDS FAIR BENCH		
Scale	Date 4/18/02	Drawn S.L.A.
GRAPEVINE INSERT		UPDATED 5/1/2024
MAT: SEE NOTES		#6737G-CU-2024

MATERIALS:
 X-BRACING: 3/16" X 1 1/4" HOT ROLLED STEEL
 BENCH LEGS: CAST DUCTILE IRON
 WOOD SLATS: CUMARU (DIPTERYX ODORATA)
 SMALL FASTENERS (CARRIAGE BOLTS, NUTS AND
 WASHERS) STAINLESS STEEL
 TIE ROD: 5/8" DIA HOT ROLLED STEEL WITH
 5/8 - 11 CUT THREADS
 & GALVANIZED STEEL HEX NUTS