

WHEN USED, ANCHOR BOLTS ARE TO BE INSTALLED IN EACH FOOT OF EACH LEG.

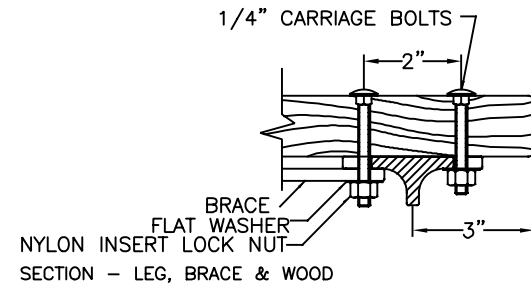
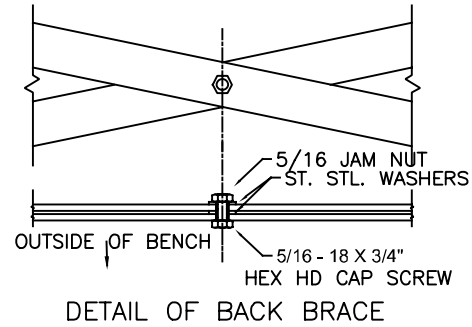
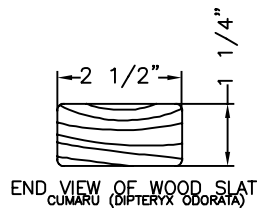

MATERIALS:

X-BRACING: 3/16" X 1 1/4" HOT ROLLED STEEL
 BENCH LEGS: CAST DUCTILE IRON
 WOOD SLATS: CUMARU (DIPTERYX ODORATA)
 SMALL FASTENERS (CARRIAGE BOLTS, NUTS AND WASHERS) STAINLESS STEEL
 TIE ROD: 5/8" DIA HOT ROLLED STEEL WITH 5/8 - 11 CUT THREADS & GALVANIZED STEEL HEX NUTS

KENNETH LYNCH & SONS

114 WILLENBROCK RD.
 OXFORD, CT 06478
 PH: 203-264-2831
 INFO@KLYNCHANDSONS.COM

6737C ARMLESS WORLDS FAIR BENCH		
Scale FAX	Date 5/1/2024	Drawn T.J.D.
NATURAL CUMARU		4' LONG
2 LEGS	CONTRACT #	
6737C-4-CU-2024		