

8 FOOT BENCH
 LENGTH OF AVAILABLE BENCHES: 4', 5', 6', 8'
 BENCHES OF LESS THAN 8' LENGTH
 HAVE 2 LEGS

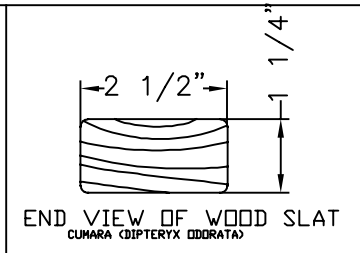
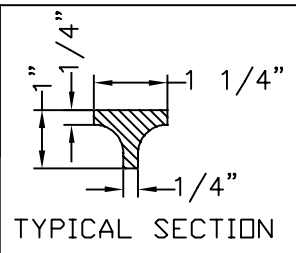
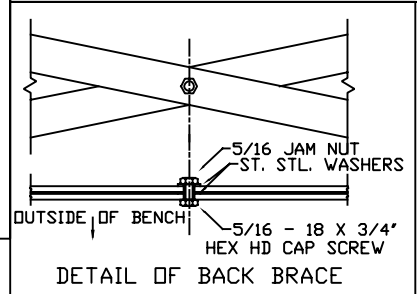

KENNETH LYNCH & SONS
 114 WILLNEBROCK RD. OXFORD, CT 06478
 203-264-2831 INFO@KLYNCHANDSONS.COM

| | | |
|----------------------------------|-------------|----------------|
| 6737-A WORLDS FAIR BENCH | | |
| Scale | Date 4/6/98 | Drawn S.L.A. |
| UPPER & LOWER INSERTS | | Rev.: 5/1/2024 |
| NATURAL CUMARU | | #6737A-CU |

MATERIALS:
 X-BRACING: 3/16" X 1 1/4" HOT ROLLED STEEL
 BENCH LEGS & INSERTS: CAST DUCTILE IRON
 WOOD SLATS: CUMARU (DIPTERYX ODORATA)
 SMALL FASTENERS (CARRIAGE BOLTS, NUTS AND
 WASHERS) STAINLESS STEEL
 TIE ROD: 5/8" DIA HOT ROLLED STEEL WITH
 5/8 - 11 CUT THREADS
 & GALVANIZED STEEL HEX NUTS