

PIN-IN-TORX TAMPER
RESIST SHEET METAL SCREW 18-8 STAINLESS
STEEL, BUTTON HEAD, NO 14 SIZE, 1-1/2" LENGTH
NOT VISIBLE FROM FRONT OF BENCH

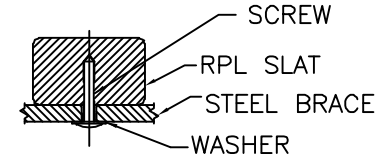

SECTION VIEW
OF RPL BENCH SLAT WITH
CROSS BRACE & SCREW -
USED ON SEAT & BACK BRACES
FROM BOTTOM & BACK OF
BRACES - 16 REQUIRED

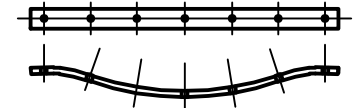
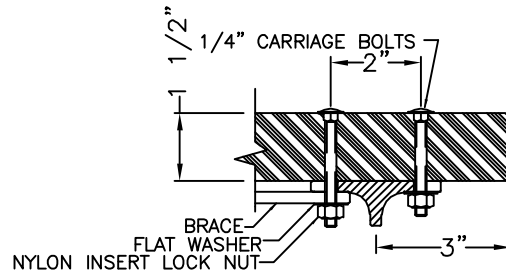
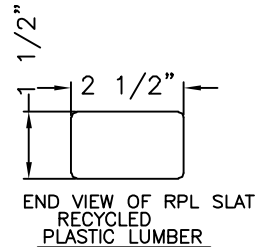
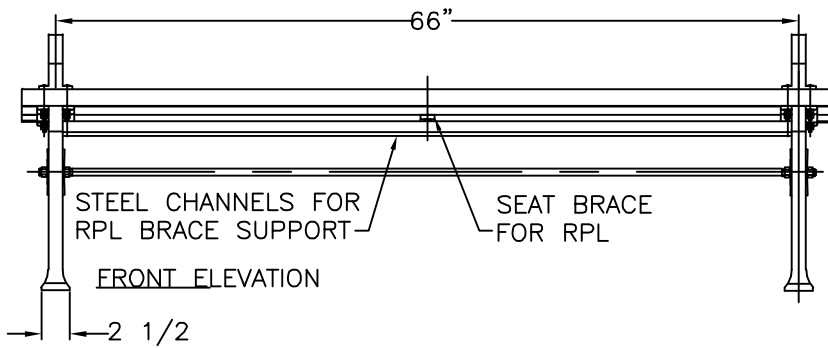

SEAT BRACE FOR RPL
3/8" X 1 1/4" HRS.
2 REQUIRED

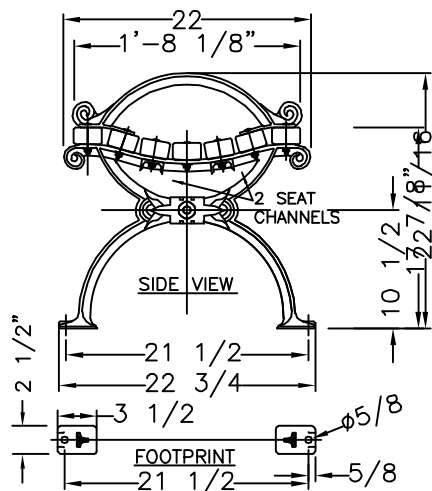

COLOR:
RPL _____
CI & STEEL: BLACK
MATERIALS:
BENCH LEGS: CAST DUCTILE IRON
SEAT SLATS: RECYCLED PLASTIC LUMBER (RPL)
SMALL FASTENERS (CARRIAGE BOLTS, NUTS AND
WASHERS) STAINLESS STEEL
TIE ROD: 5/8" DIA HOT ROLLED STEEL WITH
5/8 - 11 CUT THREADS & STEEL HEX NUTS
CROSS BRACE: 3/8" x 1 1/4" HOT ROLLED STEEL
LONG BRACE: 3/16" x 1" x 2" STEEL CHANNEL

WHEN USED, ANCHOR
BOLTS ARE TO BE
INSTALLED IN EACH
FOOT OF EACH LEG.

**KENNETH LYNCH
& SONS**
114 WILLENBROCK RD.
OXFORD, CT 06478
PH: 203-264-2831
INFO@KLYNCHANDSONS.COM

6736C WORLDS FAIR BACKLESS BENCH

Scale FAX	Date 8/18/22	Drawn T.J.D.
RECYCLED PLASTIC SLATS		6' LONG
2 LEGS	CONTRACT #	
6736C-6-RPL-FX-2022		