

PIN-IN-TORX TAMPER  
 RESIST SHEET METAL SCREW 18-8 STAINLESS  
 STEEL, BUTTON HEAD, NO 14 SIZE, 1-1/2" LENGTH  
 NOT VISIBLE FROM FRONT OF BENCH

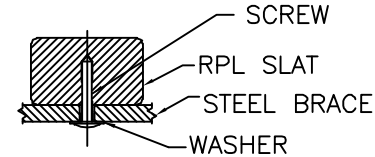

SECTION VIEW  
 OF RPL BENCH SLAT WITH  
 CROSS BRACE & SCREW -  
 USED ON SEAT & BACK BRACES  
 FROM BOTTOM & BACK OF  
 BRACES - 16 REQUIRED

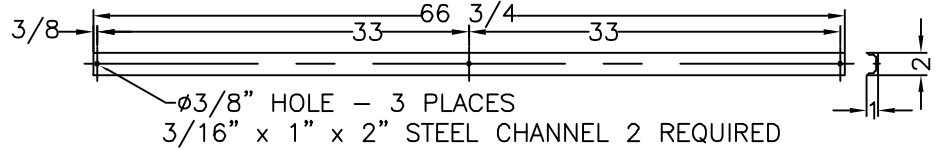
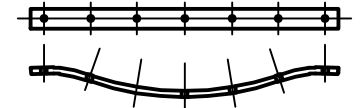
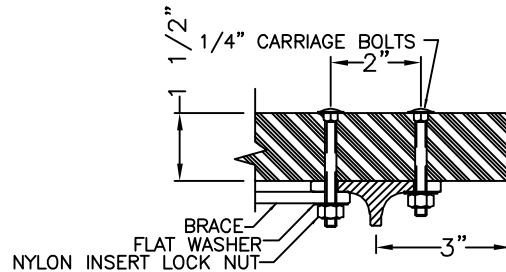
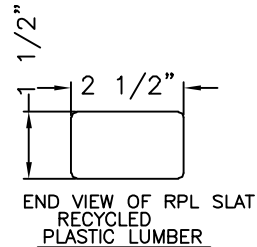
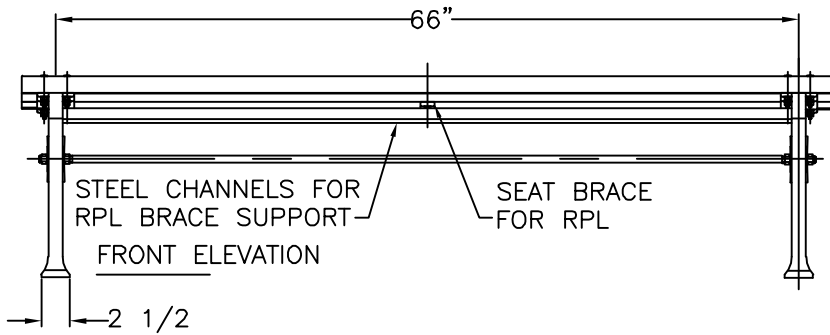

SEAT BRACE FOR RPL  
 3/8" x 1 1/4" HRS.  
 2 REQUIRED

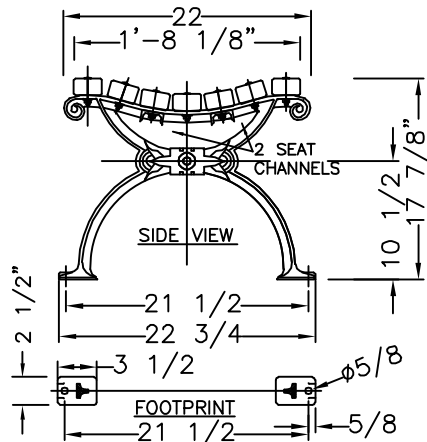

COLOR:  
 RPL \_\_\_\_\_  
 CI & STEEL: BLACK  
 MATERIALS:  
 BENCH LEGS: CAST DUCTILE IRON  
 SEAT SLATS: RECYCLED PLASTIC LUMBER (RPL)  
 SMALL FASTENERS (CARRIAGE BOLTS, NUTS AND  
 WASHERS) STAINLESS STEEL  
 TIE ROD: 5/8" DIA HOT ROLLED STEEL WITH  
 5/8 - 11 CUT THREADS & STEEL HEX NUTS  
 CROSS BRACE: 3/8" x 1 1/4" HOT ROLLED STEEL  
 LONG BRACE: 3/16" x 1" x 2" STEEL CHANNEL

WHEN USED, ANCHOR  
 BOLTS ARE TO BE  
 INSTALLED IN EACH  
 FOOT OF EACH LEG.

**KENNETH LYNCH  
 & SONS**  
 114 WILLENBROCK RD.  
 OXFORD, CT 06478  
 PH: 203-264-2831  
 INFO@KLYNCHANDSONS.COM

<b>6736 WORLDS FAIR BACKLESS BENCH</b>		
Scale FAX	Date 8/18/22	Drawn T.J.D.
<b>RECYCLED PLASTIC SLATS</b>		<b>6' LONG</b>
<b>2 LEGS</b>	CONTRACT #	
6736-6-RPL-FX-2022		