

8 FOOT BENCH  
 LENGTH OF AVAILABLE BENCHES: 4', 5', 6', 8'  
 BENCHES OF LESS THAN 8' LENGTH  
 HAVE 2 LEGS

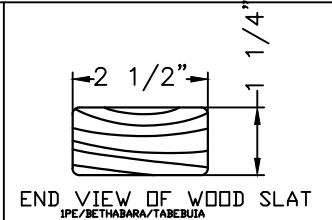
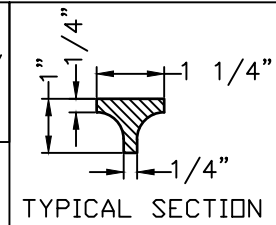
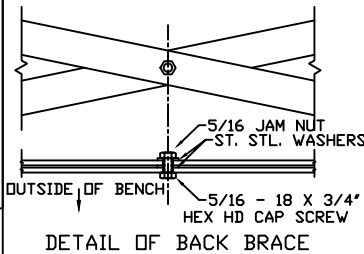

**KENNETH LYNCH & SONS**  
 114 WILLENBROCK ROAD OXFORD, CT 06478  
 PHONE 203-264-2831 FAX 203-264-2833

**MATERIALS:**

X-BRACING: 3/16" X 1 1/4" HOT ROLLED STEEL  
 BENCH LEGS & INSERT: CAST DUCTILE IRON  
 WOOD SLATS: IPE (BETHABARA)/TABEBUIA  
 SMALL FASTENERS (CARRIAGE BOLTS, NUTS AND WASHERS) STAINLESS STEEL  
 TIE ROD: 5/8" DIA HOT ROLLED STEEL WITH 5/8 - 11 CUT THREADS & STEEL NUTS

**6737B WORLDS FAIR BENCH**

Scale: FAX

Date 9/10/10

Drawn S.L.A.

**UPPER INSERT STYLE 2**

MATERIALS: AS NOTED

#6737B-8 WEB